

# pressto™

## wide panel base

Ideal for quick installation and last minute displays, this innovative free-standing product is used with panels to create eye-catching signage, advertising, and other decorative floor elements.



**Features:**

- Heavy duty anodized aluminum construction
- Holds material 0.039" - 1.18". Substrates are up to 5' height
- Installation method: Knurled head screw offers maximum flexibility to safely open and close the profile and secure the display or sign
- Integrated rubber laces protect the panel and act as an anti-slip pad for secure mounting
- Application: indoor

**Packaging:**

Sold as "each".  
Kit includes: bottom base, knurled tightening knob and rubber lace.  
Assembly instructions.

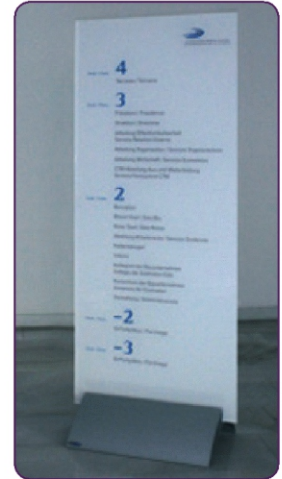

Finish	Part #	Length
Silver Matte	STD-PRE5-03	19.7"

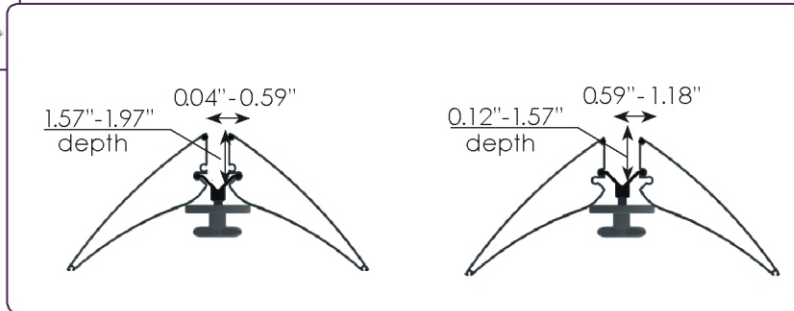
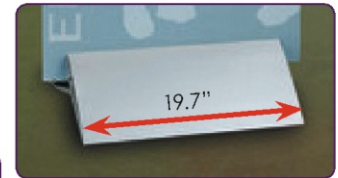

## sandwich clamp

**Features:**

- Optional sandwich clamp for use with either the **Pressto™** or **MyPressto™** bases.
- Silver-plated
- Holds material up to 0.63" thick
- Securely locks two back-to-back panels together

**Packaging:**

Sold as "each".  
Requires Allan key for sandwich connector.

**Optional:**

Components available for separate purchase: finished synthetic end caps (4 per set)

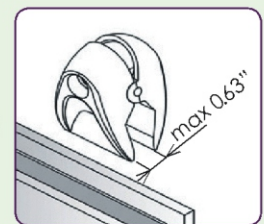
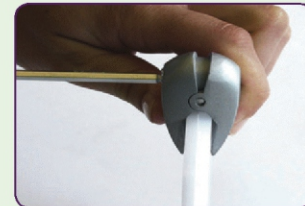

Finish	Part #
Silver	STD-PRES-CL-03